



installation guide

FOR FULLY-ADHERED VINYL SHEET FLOORING

Gerflor Foam Backed Vinyl Rolls

housing in progress

AGRIPPA | SUPER SOLAR (Residential)

TARALAY IMPRESSION CONTROL | TARASAFE ULTRA & STANDARD (Contract)

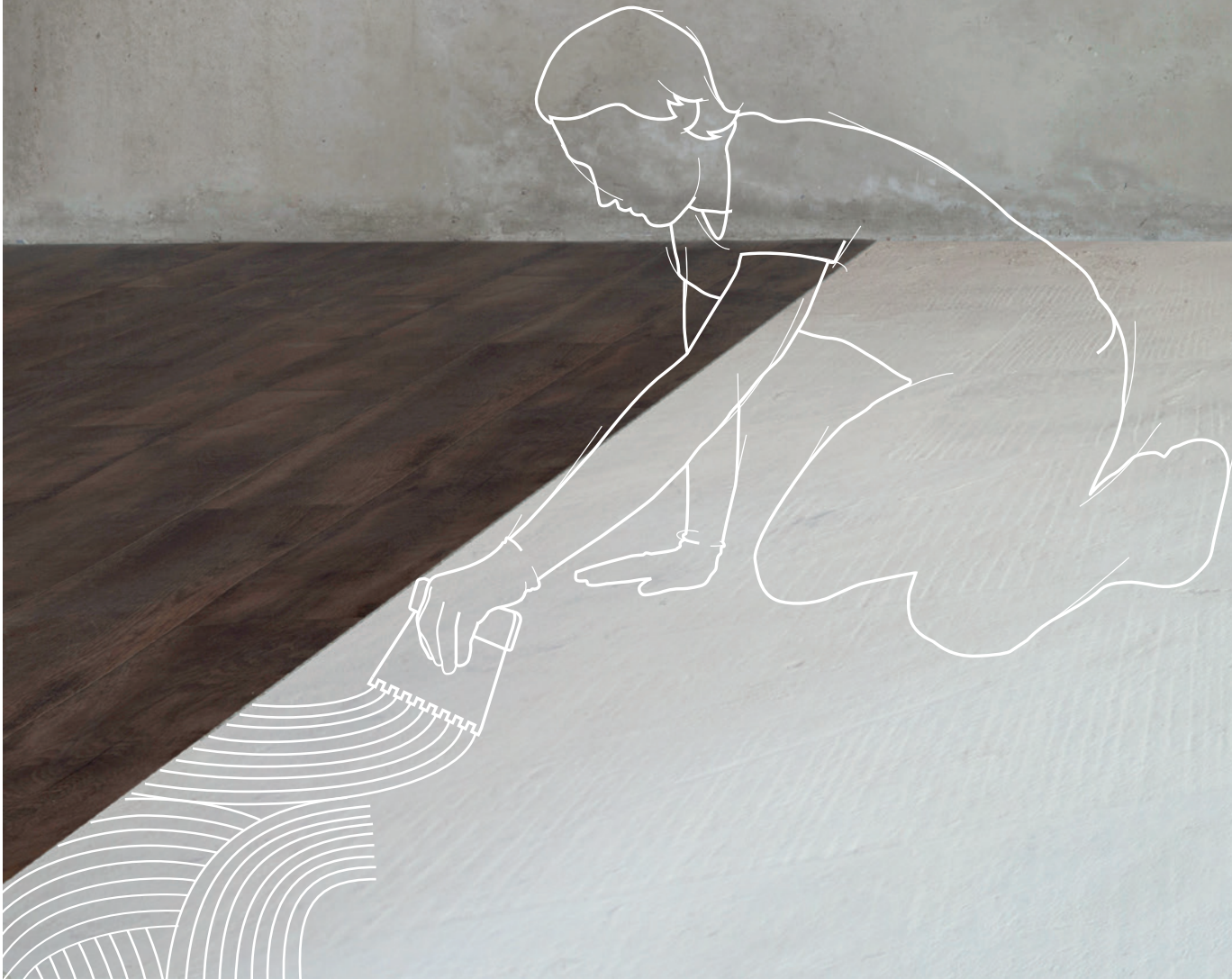

Subfloor testing & inspection

Please test the subfloor on which the floorcovering is to be laid in accordance with British Standard BS8203/8204.

Inspect the type of subfloor: i.e. sand cement screed, gypsum based self-levelling screed, cement based self-levelling screed, timber, chipboard or plywood etc, to ensure the correct subfloor preparation methods can be followed.

Prior to installing any Gerflor vinyl floorcovering, it is the flooring professionals' responsibility to ensure that the subfloor is dry, clean, smooth, flat, hard and sound with no imperfections or contaminants, in accordance with the British standards BS8203/8204,

Following a detailed inspection of the subfloor, please proceed to the subfloor preparation section.

Subfloor preparation

Once you have ensured that you are fully aware of the type of base you are to apply the vinyl floorcovering to, please carry out and complete subfloor preparation in accordance with British Standards BS8203/8304.

It may be necessary to use many products to ensure the subfloor is ready to receive the floorcovering, such as, but not limited to, latex levelling compounds, surface DPM (damp proof membranes), primer, smoothing compounds, etc.

The use of such products must be in strict accordance with the manufacturers' guidelines. Please contact the relevant product manufacturer to ensure the floor is prepared in accordance with their guidelines.

Please note: Gerflor will not accept any liability for poor subfloor preparation which may affect the finish, appearance or performance of our products. It is paramount that the prepared subfloor is level, smooth, flat, hard, dry and sound with no imperfections prior to installing any Gerflor vinyl floorcovering.

When subfloor preparation is complete, please proceed with Gerflor's installation guidelines on the following page.

SECTION 1
✓ Subfloor testing & inspection

SECTION 2
✓ Subfloor preparation

SECTION 3
✓ Installation guidelines

Installation guidelines

LAYING TECHNIQUES FOR HOMOGENEOUS & MULTI-LAYERED ROLLS COMPACT OR ACOUSTIC

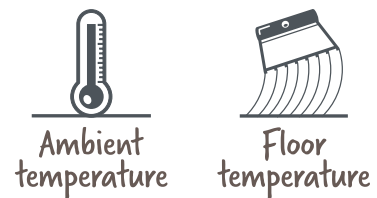

Always check the material before starting work in order to avoid problems with visible defects. Please inform GERFLOR of any visible defects discovered and do not start work without their approval.

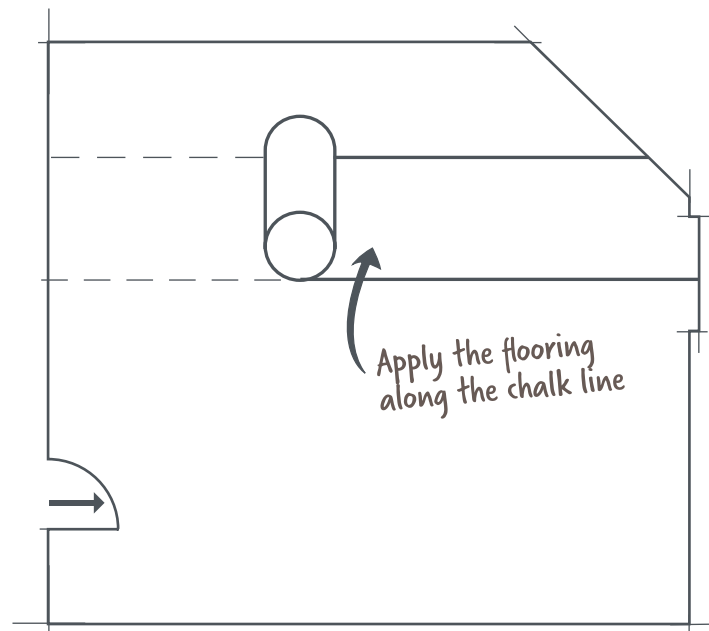

IMPORTANT:

- **Welding joints:** Leave a space of 1mm between the strips.
- **Cold seaming:** Overlap the strips in order to cut flush edges.

3- glueing and fitting

- Glue down 24 hours after positioning.
- Use acrylic emulsion adhesive.
- Spread with a fine toothed A2 type (TKB specification).
- Use a notched trowel to give an adhesive consumption rate of 300 / 350 g/m².
- To achieve this distribution, blades have to be changed regularly.

A2-type spatula

- 1 Depth
- 2 Spacing
- 3 Width

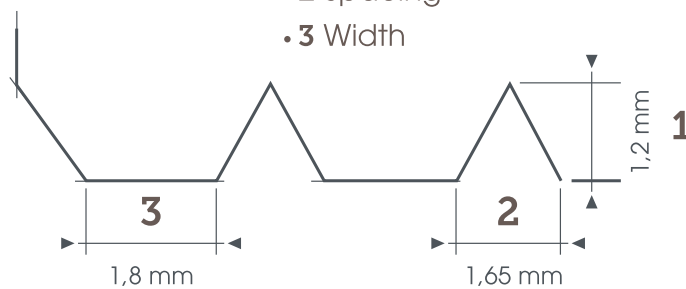

NOTE:

Closely follow the adhesive manufacturer's instructions with particular regard to its waiting time. Carefully observe tack time which depends on the temperature, relative humidity, substrate porosity and consumption.

- Too short waiting time and bubbling will occur.
- Too long waiting time will result in poor transfer of the adhesive to the flooring.
- Ensure that just sufficient adhesive is applied to the sub-floor which corresponds to the number of sheets being installed so that the adhesive's waiting time is not exceeded.
- Apply adhesive to an area no larger than can be covered within the glue's working time. Remove any surplus glue spots whilst work is in progress.
- After positioning the material, fold back the lengths in half.
- Spread the adhesive on the floor and lay the material against the chalk line.
- Repeat this procedure with the other halves.
- Do not overlap 2 films of glue when starting to apply the adhesive. Remove any surplus glue spots whilst work is in progress.
- Within corridors, the strips should be laid in the direction of pedestrian traffic unless stated otherwise in the contract specifications.

1- installation

- Rolls are clearly marked with batch numbers and the product should be checked to ensure the batches match before installing.
- Inspect all materials carefully to verify that correct colours, lot number, patterns, quality and quantities have been shipped as ordered. Do not install, cut or fit any material that has visible defects.
- A contractor that installs material that has visible defects or damage without prior consent from Gerflor deems the product acceptable for installation and therefore accepts full responsibility.

NOTE: Some rolls may have directional arrows on the reverse side. These should be installed as recommended. All rolls should be laid out in position 24 hours prior to installation.

2- positioning

- As far as possible, and depending on the width of the rolls, seams between strips should be kept away from likely areas of heavy use.
- Within rooms, the strips should be laid in the direction of the main window wall or in a lengthwise direction.

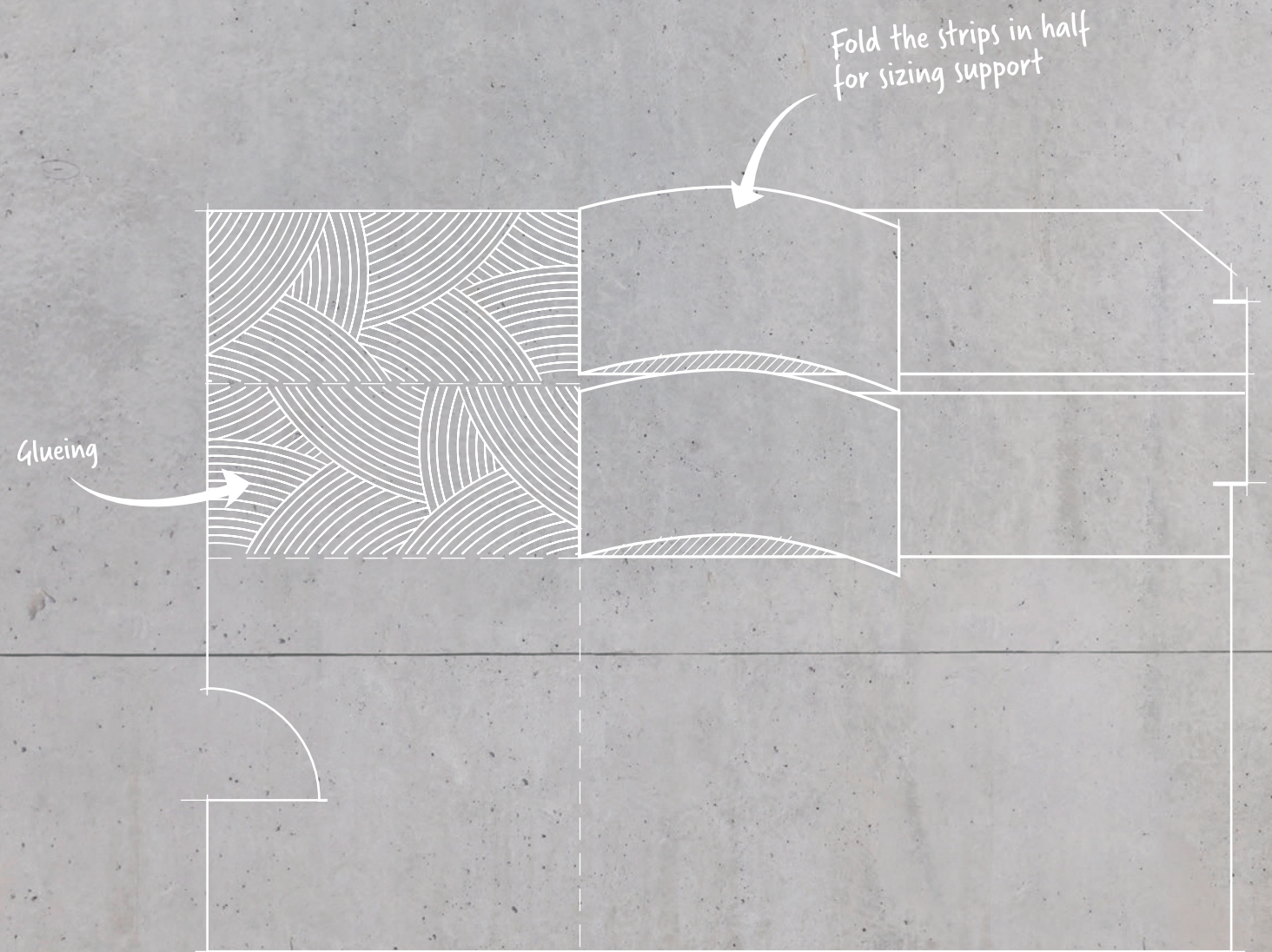

4- rolling out

This must be done in two stages:

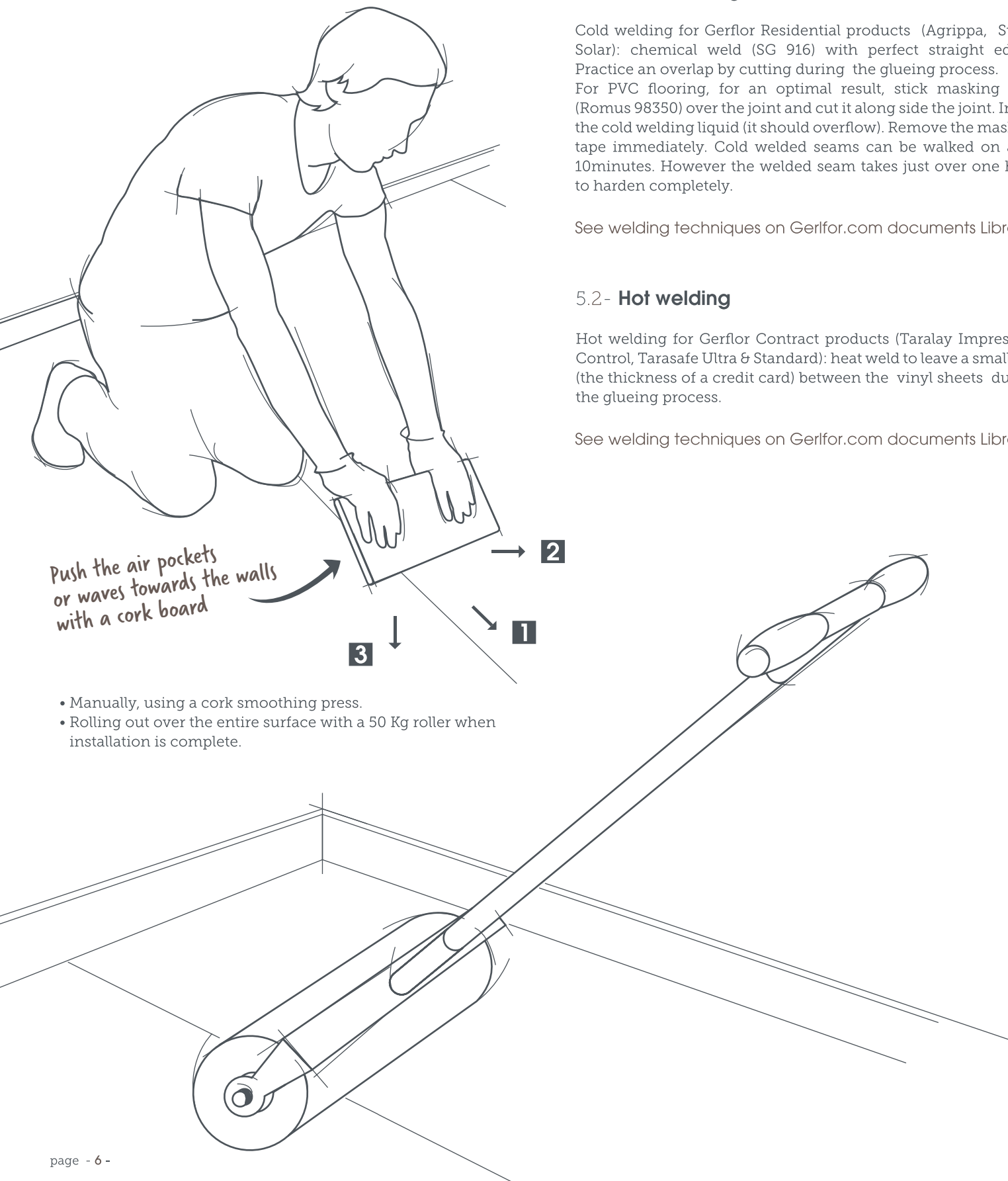

5- welding

5.1- Cold welding

Cold welding for Gerflor Residential products (Agrippa, Super Solar): chemical weld (SG 916) with perfect straight edges. Practice an overlap by cutting during the glueing process. For PVC flooring, for an optimal result, stick masking tape (Romus 98350) over the joint and cut it along side the joint. Inject the cold welding liquid (it should overflow). Remove the masking tape immediately. Cold welded seams can be walked on after 10minutes. However the welded seam takes just over one hour to harden completely.

See welding techniques on Gerflor.com documents Library

5.2- Hot welding

Hot welding for Gerflor Contract products (Taralay Impression Control, Tarasafe Ultra & Standard): heat weld to leave a small gap (the thickness of a credit card) between the vinyl sheets during the glueing process.

See welding techniques on Gerflor.com documents Library

5.2A- Manual weld with a Speed Nozzle

NOTE:
Always practice on a scrap piece of material first to assure proper temperature and speed. Doing so will prevent failures.

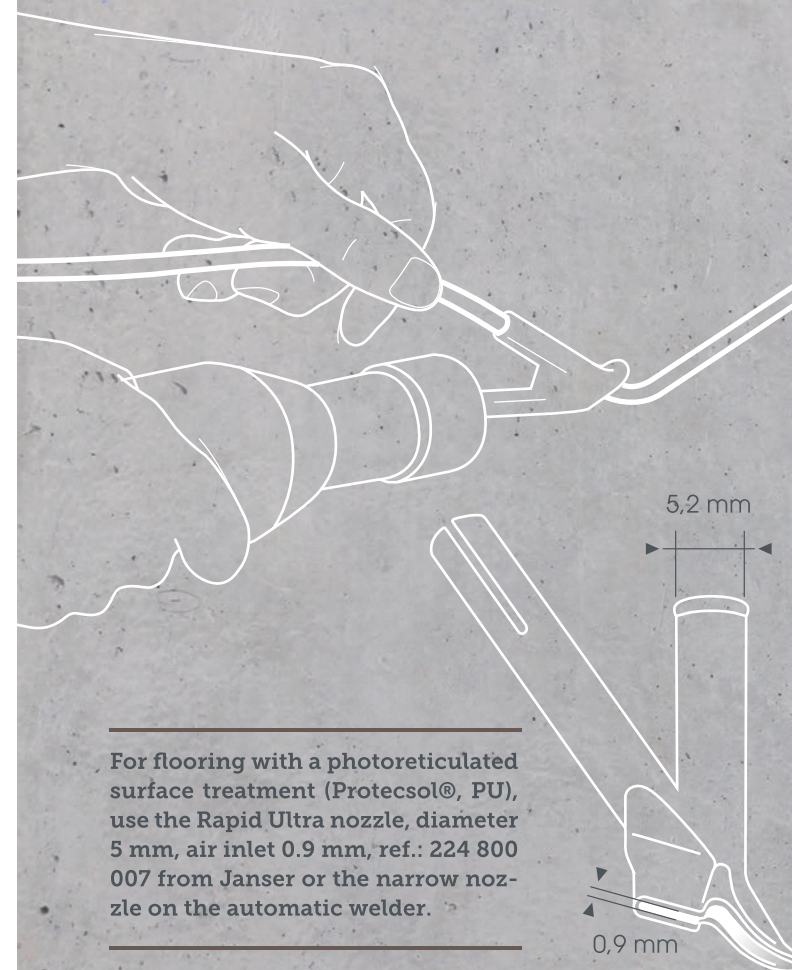

5.2B- Trimming weld zone

Trimming must be done in two stages. Using a trimming tool sharpened in the middle only, such as the Mozart, is recommend:

First stage: Has to be done with the thickness guide.



Second stage: Second trim has to be done with the trimmer only. This method prevents concave welds and must be done when the rod is cold

6- before using the flooring

After installation:

- For normal pedestrian traffic, allow 48 hours.
- Before moving or installing furniture, allow 72 hours.
- Do not use rubber furniture feet.

For under-floor heating, do not turn on the heating for 7 days after installing the tiles.



✓ **UNITED KINGDOM:** Gerflor Ltd

Wedgnoek House, Wedgnoek Lane, Warwick, CV34 5AP
Tel: + 44 (0) 1926 622600 - Fax: + 44 (0) 1926 401647
E-mail: contractuk@gerflor.com - Visit: gerflor.co.uk

✓ **IRELAND:** Gerflor Ltd

Ballybay Road, Carrickmacross, Co. Monaghan, Republic of Ireland
Tel: +353 (0) 42 966 1431 - Fax: +353 (0) 42 966 1759
E-mail: gerflorirl@gerflor.com - Visit: gerflor.ie

✓ **OTHER COUNTRIES:** Gerflor International

Tel: +33 (0)4 75 50 68 68 - Fax +33(0)4 75 50 69 99
E-mail: serviceconso@gerflor.com - Visit: gerflor.com