

CLIENT: PORTS OF JERSEY, JERSEY FERRY TERMINAL  
SOLUTION: GTI MAX

“ Gerflor’s GTI Max flooring was the only way to go. It looks amazing, and has completely transformed the terminal. The area now looks smart, bright and very welcoming. ”

Maria Le Tiec, Passenger Services Manager  
for Ports of Jersey

Steeped in tradition Jersey is the largest of the Channel Islands, sitting in the Bay of St Malo and only 5 miles long and 9 miles wide. So, not very big at all. However, with passenger travel on the increase Jersey sees more than its fair share of visitors.

In 2017 Ports of Jersey (who operate the airport and ferry terminal) announced a progressive plan to create an integrated arrivals and departures terminal. The major works programme would see an extension to the existing departures terminal building with the construction of a mezzanine floor to create a new central security search area and airside departures lounge. International flooring specialist Gerflor were on hand to supply a high-quality, fast track flooring that would provide a quick and effective solution with no need for any shutdown of the airport operation.

“ Gerflor’s GTI Max looks very smart, it’s very practical, particularly in areas of heavy footfall, it’s very versatile and easy to maintain. ”

Maria Le Tiec, Passenger Services Manager for Ports of Jersey

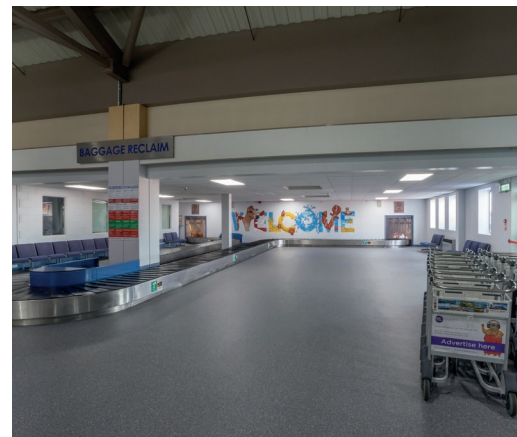
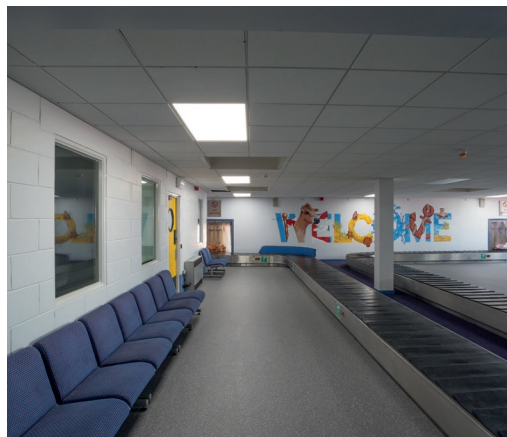

For further information on Gerflor’s extensive range of flooring solutions please contact us:

UNITED KINGDOM  
+44 (0) 1926 622 600  
[contractuk@gerflor.com](mailto:contractuk@gerflor.com)  
[www.gerflor.co.uk](http://www.gerflor.co.uk)

REPUBLIC OF IRELAND  
+353 (0) 42 966 1431  
[gerflorirl@gerflor.com](mailto:gerflorirl@gerflor.com)  
[www.gerflor.ie](http://www.gerflor.ie)

[@GerflorUK](https://twitter.com/GerflorUK)