



CITYSCENE  
& BRICKWORKS

---

**Gerflor**<sup>®</sup>  
theflooringgroup



# CITYSCENE & BRICKWORKS

Cityscene & Brickworks are tufted loop pile carpet tiles that can be used together to create interesting and contemporary floor schemes. Suitable for a wide range of environments including commercial office, education and healthcare.

## CONTENTS

Colourways.....	1
Commercial Office Scheme .....	2-3
Floor Plan .....	4-5
Education Scheme .....	6-7
Floor Plan .....	8-9
Installation .....	10-11
Scheme .....	12-13

# CITYSCENE & BRICKWORKS

Colourways

## CITYSCENE



Tin 21 07501  
LRV 17.12



Shale 21 07503  
LRV 11.13



Granite 21 07505  
LRV 8.39



Claystone 21 07502  
LRV 12.54



Rhyolite 21 07504  
LRV 9.92



Basalt 21 07506  
LRV 3.25

## BRICKWORKS



Ironstone 22 06707  
LRV 7.90



Tonbridge 22 06711  
LRV 4.49

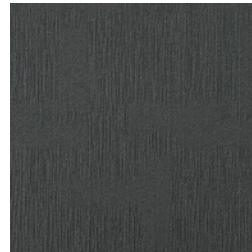

Himley 22 06709  
LRV 3.05

### Cityscene



Broadloom

### Cityscene Brickworks



Quarter Turn

### Cityscene Brickworks



Brick Bond

COMMERCIAL OFFICE SCHEME

Cityscene | Brickworks



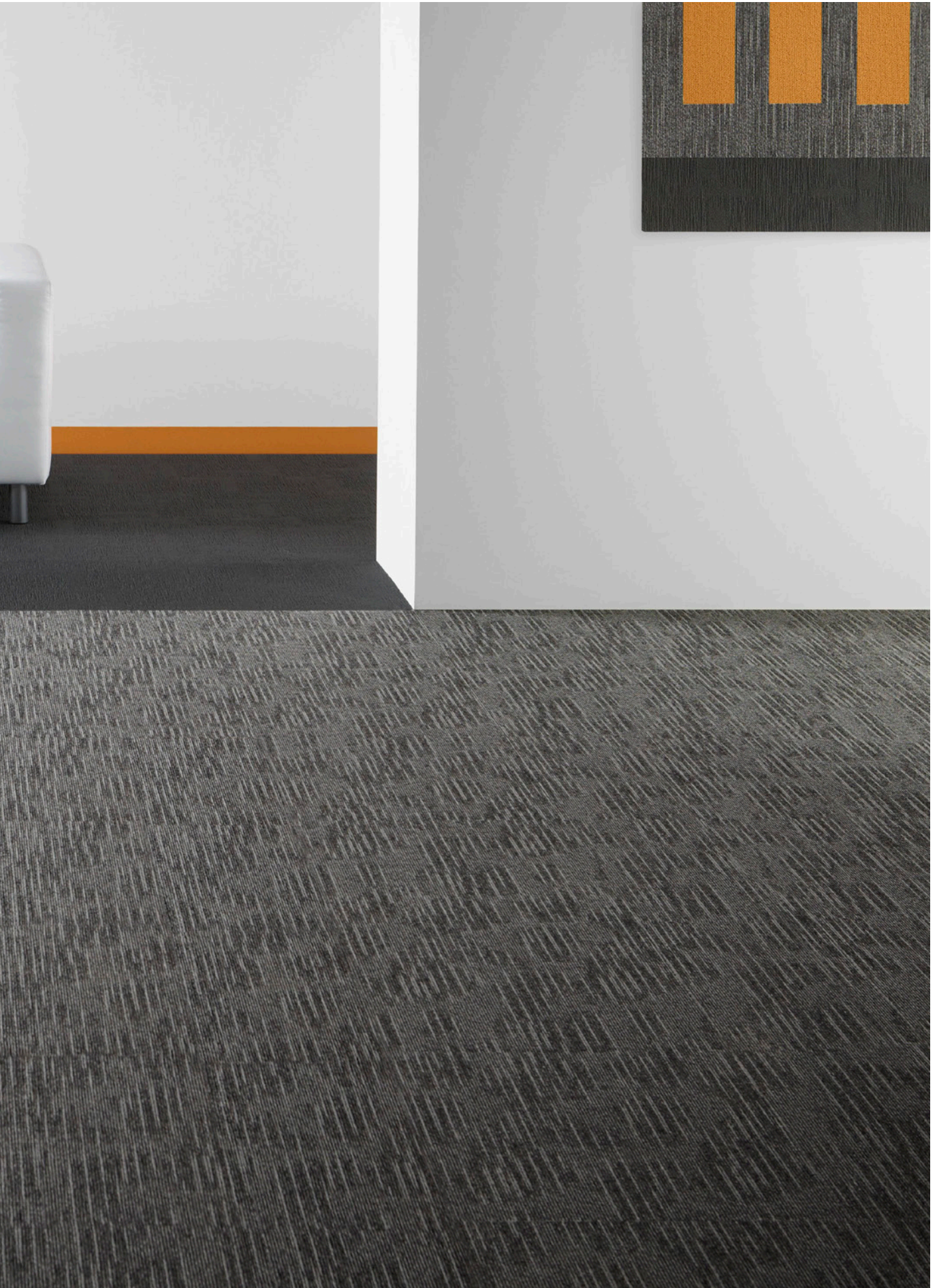

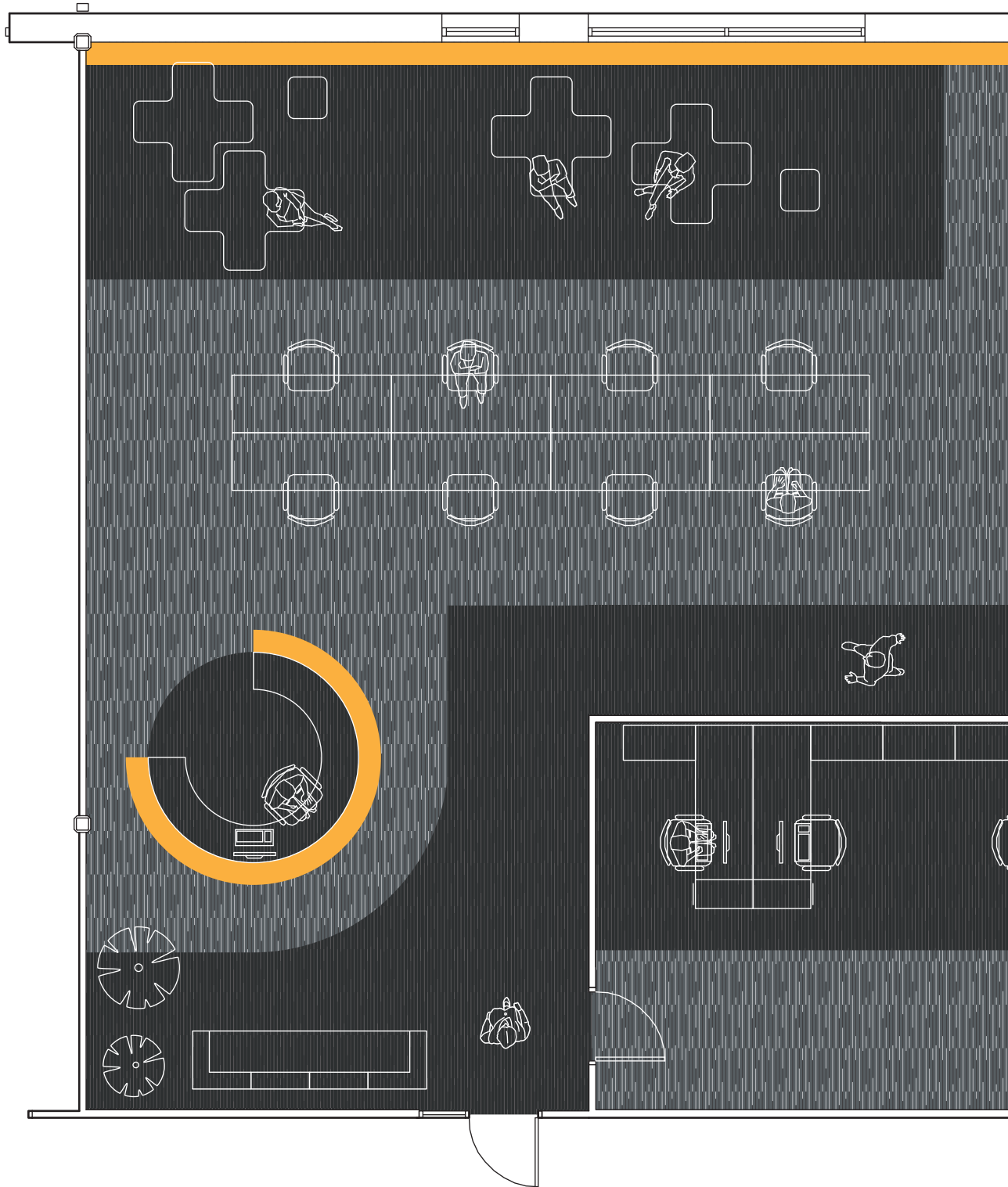

COMMERCIAL OFFICE FLOOR PLAN

Cityscene | Brickworks

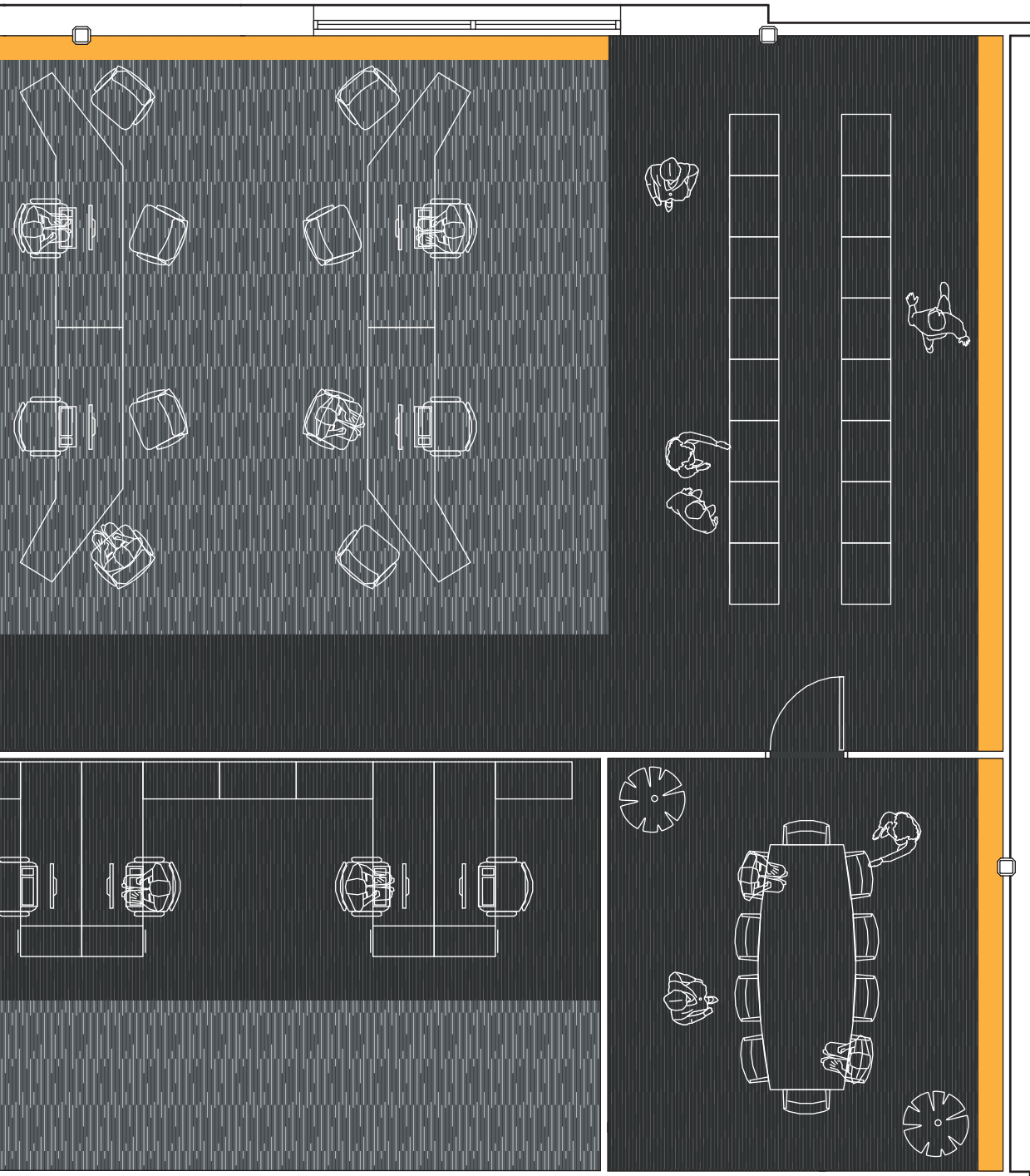





 Cityscene  
 Granite 21 07505  
 (Installed brick bond)

 Brickworks  
 Himley 22 06709  
 (Installed brick bond)

EDUCATION SCHEME

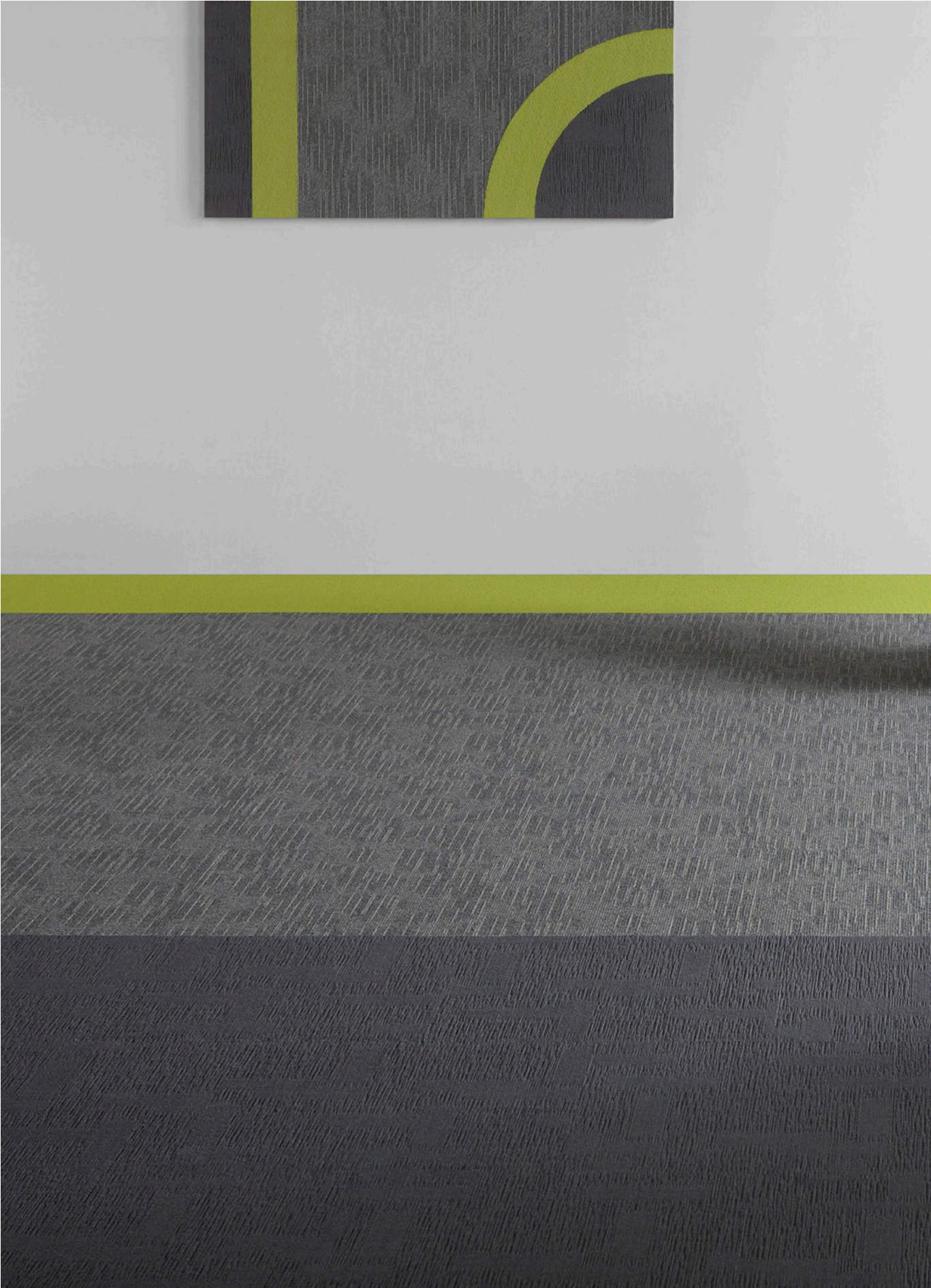
Cityscene | Brickworks







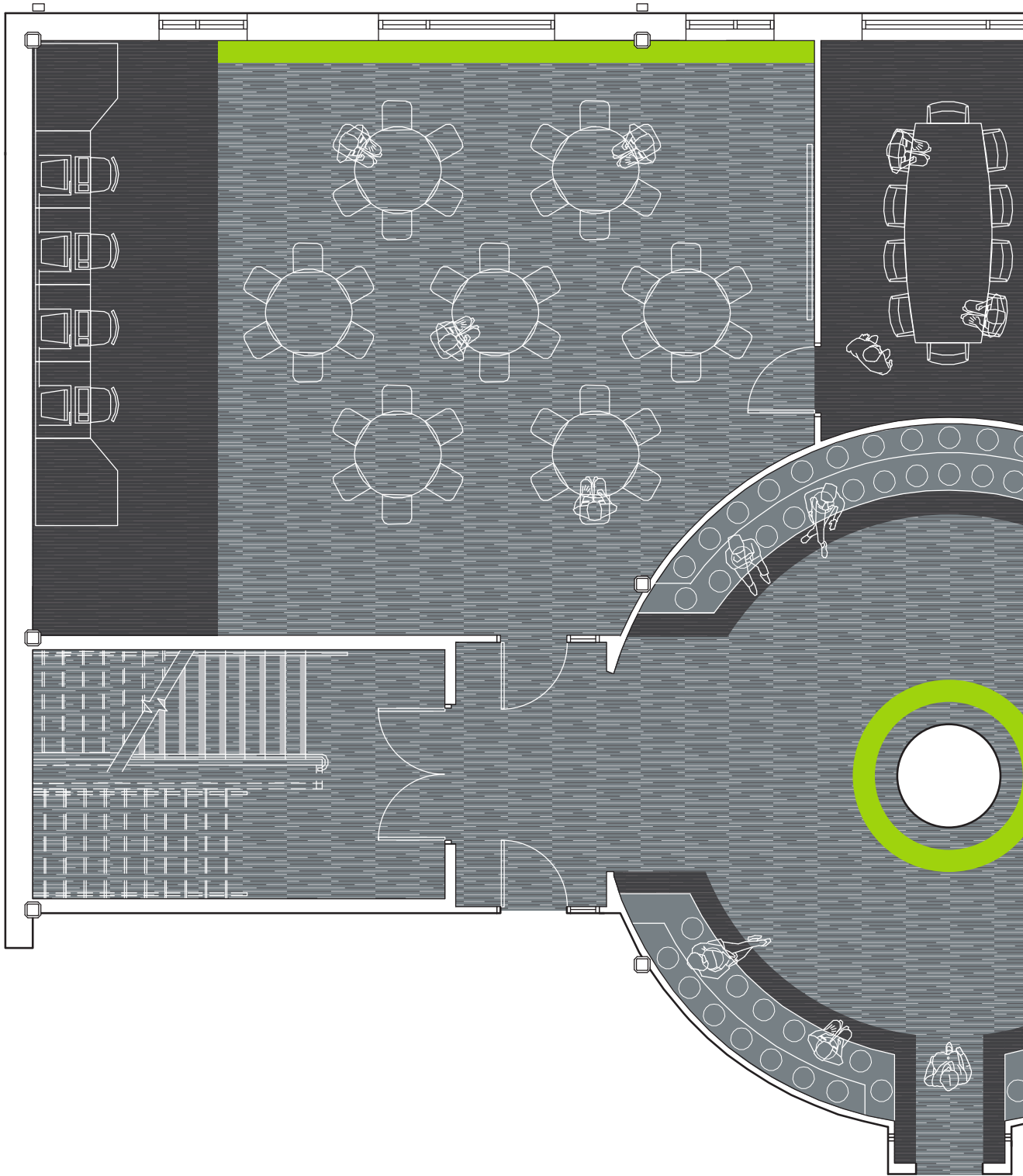

# EDUCATION FLOOR PLAN

Cityscene | Brickworks

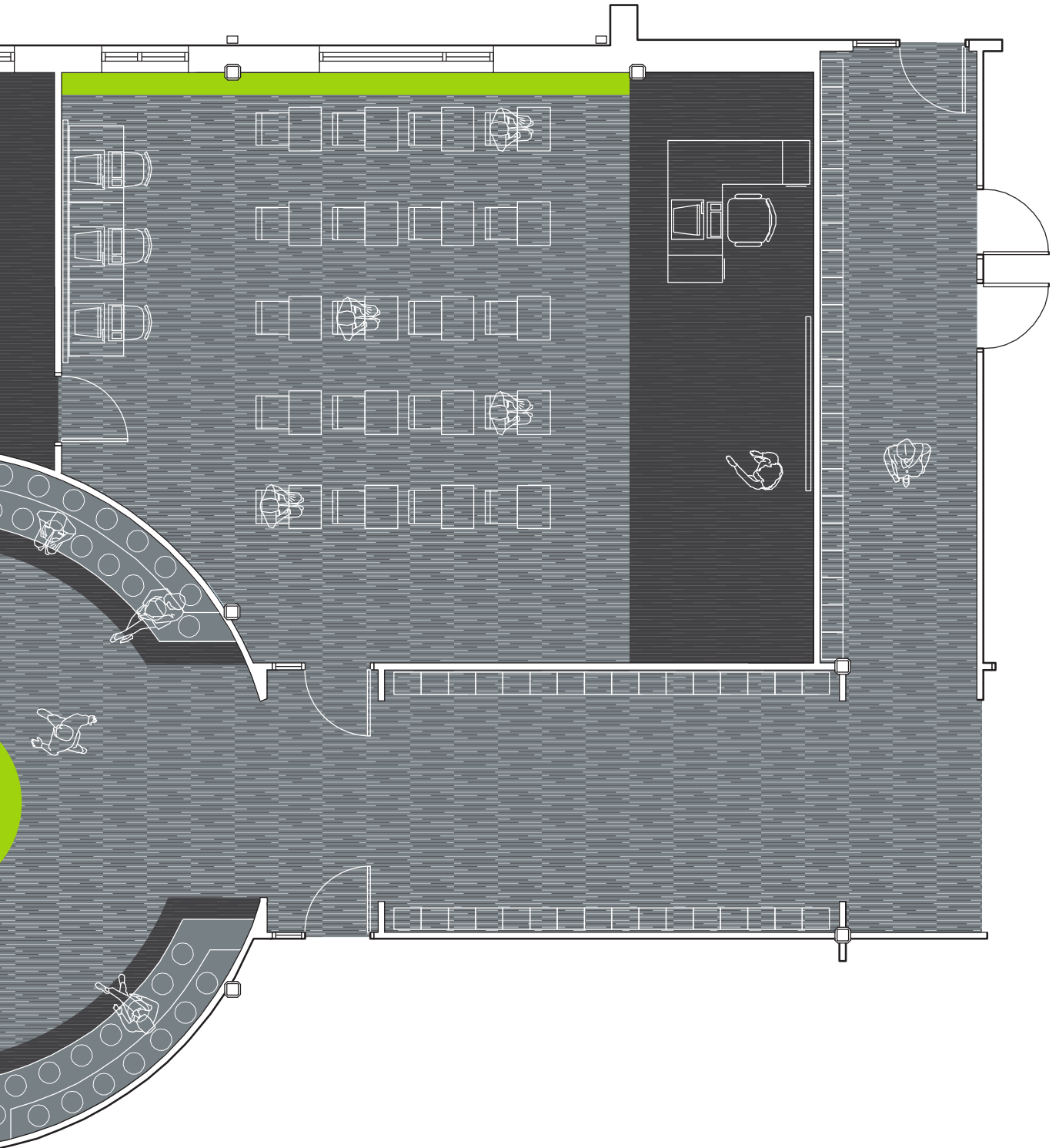



 Cityscene  
Shale 21 07503  
(Installed brick bond)

 Brickworks  
Tonbridge 22 06711  
(Installed brick bond)

# CITYSCENE & BRICKWORKS INSTALLATION

Cityscene | Brickworks

Image shows 12 tiles

Cityscene



Quarter Turn

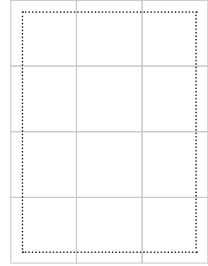

Cityscene Shale 21 07503 with Brickworks Tonbridge 22 06711

Image shows 12 tiles

Cityscene

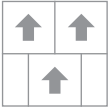

Brick Bond

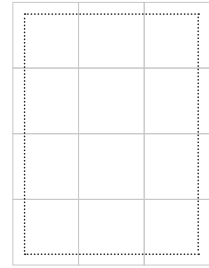

Cityscene Granite 21 07505 with Brickworks Himley 22 06709

CITYSCENE & BRICKWORKS SCHEME

Cityscene | Brickworks





Uniclass Pr_35_57_11_62
CI/SfB (43) Tn6

## CITYSCENE

## BRICKWORKS

### SPECIFICATION

Product Format	Tile	Tile
Product Dimensions	500mm x 500mm	500mm x 500mm
Product Construction	Tufted Loop Pile	Tufted Textured Pattern Loop Pile
Surface Yarn	100% Solution Dyed Nylon	100% Antron® Lumena™ Solution Dyed Nylon 6.6
Total Carpet Weight	3880 g/m <sup>2</sup>	4290 g/m <sup>2</sup>
Tufted Pile Weight	650 g/m <sup>2</sup>	800 g/m <sup>2</sup>
Gauge	1/12" (47.2 per dm)	1/12" (47.2 per dm)
Stitches	47.5 per dm	54.0 per dm
Primary Backing	Non-woven	Non-woven
Secondary Backing	Bitumen (contains 75% recycled material)	
Total Carpet Thickness	5.8mm	6.5mm

### PERFORMANCE SPECIFICATION

Classification BS EN 1307	Class 33	Wear Class 33
Castor Chair BS EN 985 Test A	Pass	Pass
Static Electricity ISO 6356	<2kV	<2kV
Impact Sound Insulation EN ISO 10140-3	26dB	26dB

### FLAMMABILITY

BS EN 13501-1	Class Bfl-s1	Class Bfl-s1
---------------	--------------	--------------

### WARRANTIES

Wear Warranty	10 Year	10 Year
Anti-static Warranty	10 Year	10 Year

### ADHESIVES

For recommended adhesives contact Technical Services.



EPD - awaiting validation

The information contained in this document is valid from 1/6/2023 and is subject to change at any time without notice.

### Contact us to order free samples

#### UNITED KINGDOM:

Gerflor Flooring UK Ltd  
Park Green, Macclesfield,  
Cheshire, SK11 7LZ  
Tel: 01625 428922  
E-mail: contractuk@gerflor.com  
Visit: www.gerflor.co.uk

#### IRELAND:

Gerflor Ltd  
Ballybay Road, Co. Monaghan,  
A81 YD83, Republic of Ireland  
Tel: +353 (0) 42 966 1431  
E-mail: gerflorir@gerflor.com  
Visit: www.gerflor.ie